

SEPTEMBER 27, 2022

PRODUCT ANNOUNCEMENT



A New Addition to **ATRO's** Steer King Line

SKS0894618

Spiral Kit - KH946R

Fitment: MCI, 102DL3, 16000# & 20000# FH-946;

Rockwell/Meritor, 600 Series: 16000# FH-941 20000# FH-945 FH-946;

Gillig: 16000# FH-946

Qty Per Vehicle: 1

Cross References

Stemco: KH946R, 78.946.18

MCI: 01-01-1079

Meritor: R201424

Gillig: 82-24530-000, 83-28305-000

Install Tools

Long T-Handle: SKT060L

Short T Handle: SKT060S

Seal Driver: SKPT122E

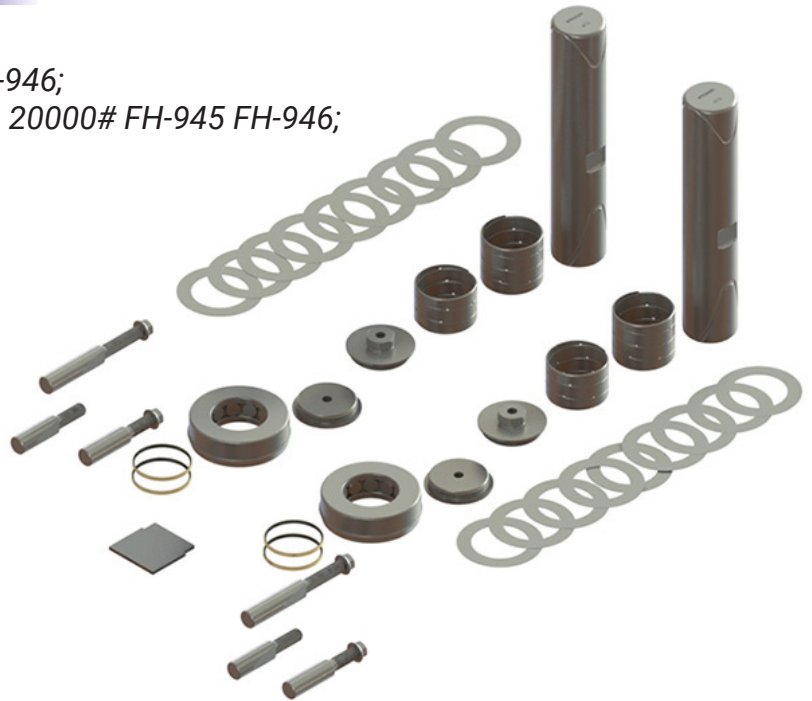

STEER KING

by **ATRO**

Save time in the shop.

Like ATRO's specialty engineered products, our Steer King Line offers long-lasting, no-ream King Pin kits that install fast and reduce downtime.

Steer King installs are known for being clear-cut and hassle-free, which saves time and boosts productivity for both shops and owners.

High-quality, precision engineering.

ATRO's Steer King kits include precision machined components with all critical dimensions 100% inspected for a true fit.

Scan QR code
for more info on
ATRO's Steer King line



ATRO

ENGINEERED SYSTEMS

With ATRO behind you, **drive forward.**

SUSPENSION | TRAILER | STEERING | TORQUE ROD | UNDERCAB/HOOD | SERVICE PARTS | TOOLS

PA019-092722

6 Bolte Lane

St. Clair, Missouri 63077 • U.S.A.
800.325.6114 • Fax 866.920.2005

ATRObushing.com

©2022 ATRO ENGINEERED SYSTEMS, INC.

ATRO Engineered Systems, Inc. is not liable for any errors herein. All manufacturers' names and part numbers are used without permission; no endorsement, affiliation, or recommendation is implied. They are included for reference purposes only.